

Set-up Instructions

NetUpScreen

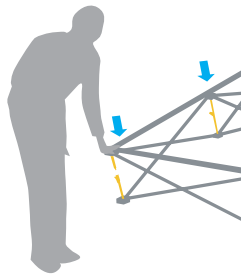

1. Unfold the structure with the perimeter tape of Velcro upwards. Although they seem equal, each structure has a superior and inferior part. The inferior part is recognized because its hubs take an additional screw (see drawing A). This screw will serve to place the stabilizing feet.

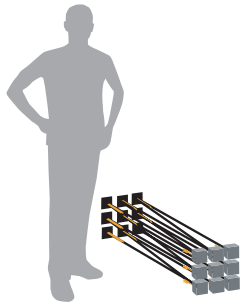
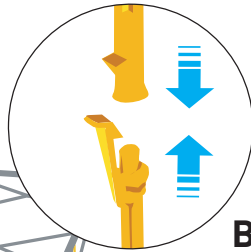
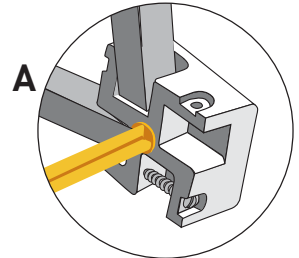

B

2. Once unfolded on the ground, close all the lockers (see drawing B).

3. In order to place the image, we recommend fixing the fabric or canvas starting with the inferior part of the structure.

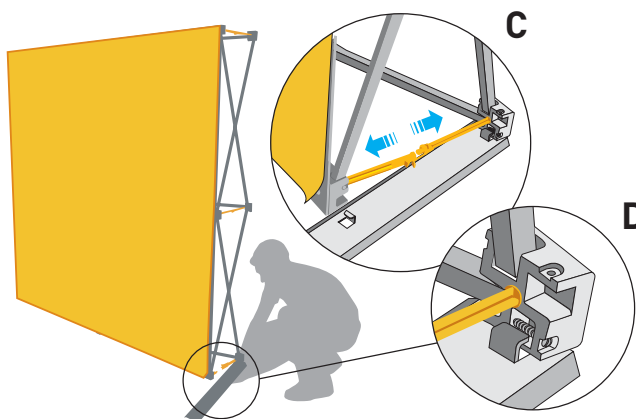
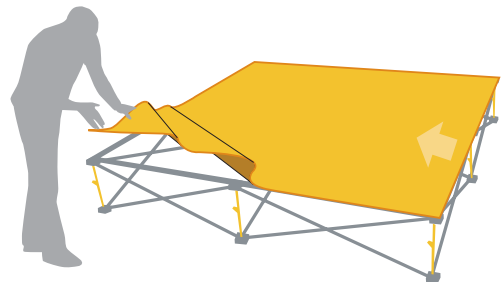

4. In order to install the stabilizing feet, open the corresponding locker once again (see drawings C and D). Once the foot is installed, close the locker again.

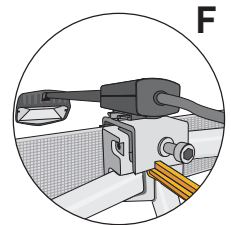
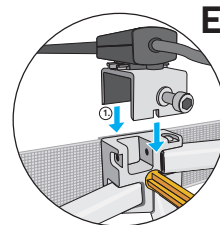

5. To place the spotlight, insert the spotlight connector notch onto the orange locker (see drawing E). Tighten the screw until the connector is firmly in place (see drawing F).

ATTENTION

TO CLOSE THE STRUCTURE, REMEMBER TO OPEN ALL THE LOCKERS BEFORE FOLDING IT.
OPEN AND CLOSE THE STRUCTURE CAREFULLY.